

DRIVE THRU, RIVERSIDE BUSINESS PARK, NORTHAMPTON

OVERVIEW

CLIENT

Tim Hortons

SECTORS

Retail

LOCATION

Northampton

PLANNING AUTHORITY

Norhampton Borough Council

HIGHWAY AUTHORITY

Northamptonshire County Council

PROJECT TEAM

Williams Gallagher
Beyond

PROJECT MANAGER

Andrew Snowden

PROJECT DIRECTOR

Daniel Ekstrand

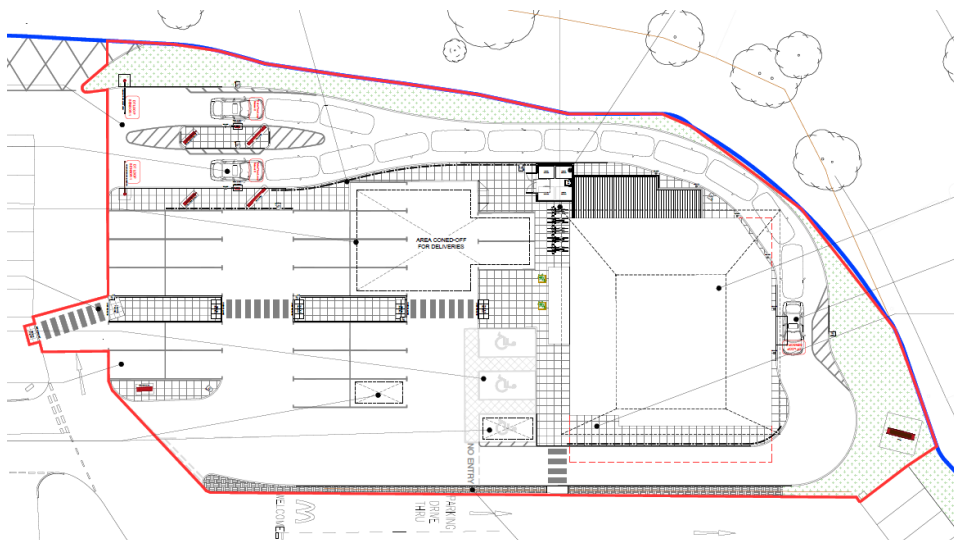

PROJECT

We were instructed by Tim Hortons to support an application for the redevelopment of an existing Pizza Hut restaurant to provide a Tim Hortons Drive Thru restaurant. As Tim Hortons are legally permitted to occupy the store without the need for planning permission, the proposals simply comprised the addition of a drive thru lane.

APPROACH

Given the relatively small scale of the proposals in comparison to the lawfully permitted use, we prepared a short Transport Statement to examine the key transport related issues. This included a review of car parking provision, noting that the proposals would result in a reduction of six spaces, and swept path assessments to confirm the suitability of the proposed servicing and refuse collection.

As the proposals did not result in any change of the use of the unit and there was no significant change in floor area, it was not considered that there would be any material change in primary trip attraction.

Following submission of the planning application, a query was raised by the highway officer in relation to the potential for queuing from the drive thru lane to obstruct traffic. We prepared a response to this which demonstrated that queuing would be unlikely to exceed the drive thru lane, and that there was sufficient space within the car park to allow vehicles to pass should queuing occur.

OUTCOME

The planning application was granted permission on 19th April 2021.

RELATED PROJECTS

Drive Thru, Bentley Bridge Retail Park, Wednesfield

